

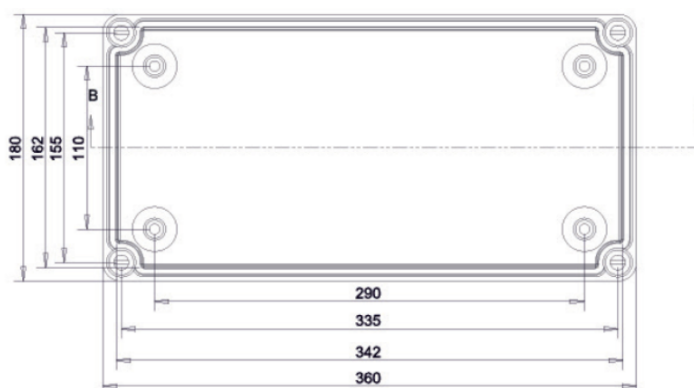

Description	
	Monitoring and control systems are boxes in which the equipment necessary for an application is mounted, wired, configured and programmed. Thus achieving a product that offers a complete solution, only having to install the box and connect the power.
Featured Features	
	<ul style="list-style-type: none"> - Plug&Play - Equipment already assembled, wired, configured and programmed -LoRa communication - Built-in electrical safety - Versatility for a multitude of applications
Application	
	System to collect data and communicate it through LoRa communication to another system that does have management capacity
Examples	<ul style="list-style-type: none"> - Flowmeter (Parshall Channel, etc...) - Tank level control - Control of voltages, current, consumption, etc... - Well-Deposit
Electrical data	
Power supply	220.. 240 VAC
Environmental conditions	
Temperature	-10 .. +50 °C
Humidity	10%.. 90%
Mechanical data	
Protection degree	IP-66 and IK-10
Dimensions	360x180x170mm
Installation	
Inside	Yes
Outside	Yes
Recessed	Yes
Wall	Yes
Floor	No
Post	Yes
Characteristics and electrical safety	
Isolator switch	3P, Current 32A, Power 11kW, IP65
Magnetothermal circuit breaker	1 pole, 277V ac, 2A
Normative	ITC-BT-17
Electrical behavior of the box	
Rated voltage CC up to	1500 VDC
Rated AC voltage up to	1000 VAC
Maximum heat dissipation	65,5 W

Radio communication	
Type	LoRa
Range	Up to 1 km coverage indoors and 15 km outdoors
Serial interface	
Type	RS-485 three threads (A+/S GND/ B-) (RX/GND/TX)
Digital input features	
Type	Optoisolated voltage free (dry contact)
Maximum activation current	50mA
Characteristics digital outputs	
Type	Relay
Nominal voltage	250 VAC
Electrical endurance	3·10 ⁴ operations
Rated Current	
With resistive load	250 VAC / 5 AAC
With inductive load (AC)	250 VAC / 5 AAC
With inductive load (DC)	24 VDC / 5 ADC
Dimensions	



Opaque format



Electric scheme

